

**LEGEND**

- DECIDUOUS TREE
- MULTI-STEM TREE
- CONIFEROUS TREE
- SHRUBS & PERENNIALS
- SODDED AREA
- SEEDED AREA

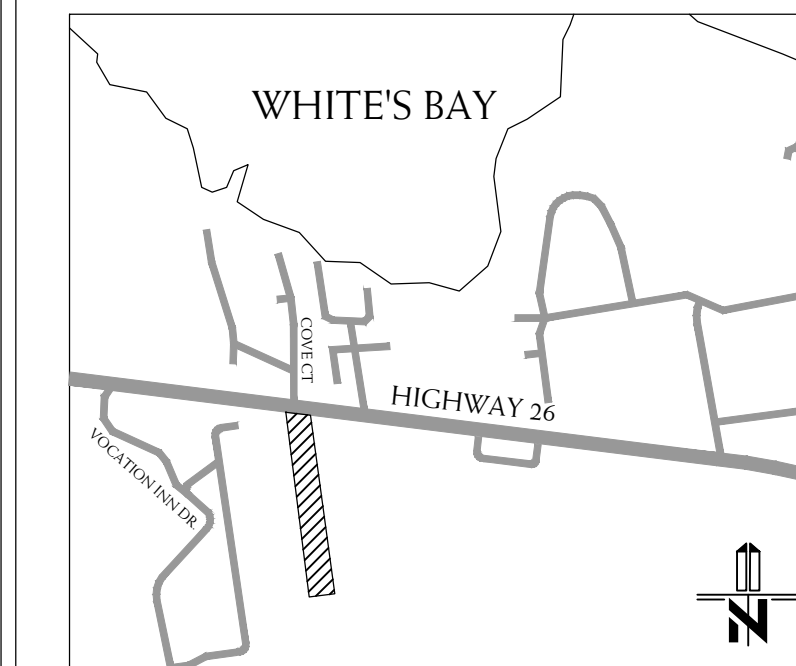

BASE INFORMATION OBTAINED ELECTRONICALLY FROM 2LS DESIGN (JOB NO. 2020-14; TEL. 647-456-2828)

no.	date	version	by
2.	AUG 1 2023	ISSUED FOR SUBMISSION	LE /EK
1.	DEC 5 2022	ISSUED FOR SUBMISSION	KM /EK
0.	OCT. 22 2021	ISSUED FOR CLIENT REVIEW	NH

All information hereon to be checked and verified at the site and any discrepancies must be reported to and clarified by the landscape architect before commencing work. All drawings, specifications, details, digital information, etc., prepared by the landscape architect are instruments of service and as such are his property and must be returned at his request.

**ALEXANDER BUDREVICS**  
LANDSCAPE ARCHITECTS

895 Don Mills Road, Second Tower, Suite 212  
Toronto, Ontario, Canada, M3C 1W3

416.444.5201  
416.444.5208

www.budrevics.com

project  
**11589 HIGHWAY 26**  
**CRANBERRY MARSH ESTATES**  
 HIGHWAY 26  
 TOWN OF COLLINGWOOD  
 CRANBERRY MARSH ESTATES

drawing

**LANDSCAPE PLAN**

date	OCT 20, 2021	drawn	NH
scale*	1:400	file	3523 L1 V2-010823
direction		project no.	3523
		sheet no.	L-1

\*NOTED SCALE IS APPLICABLE ONLY WHEN PRINTED ON ARCH D (34"x36") SIZE SHEET

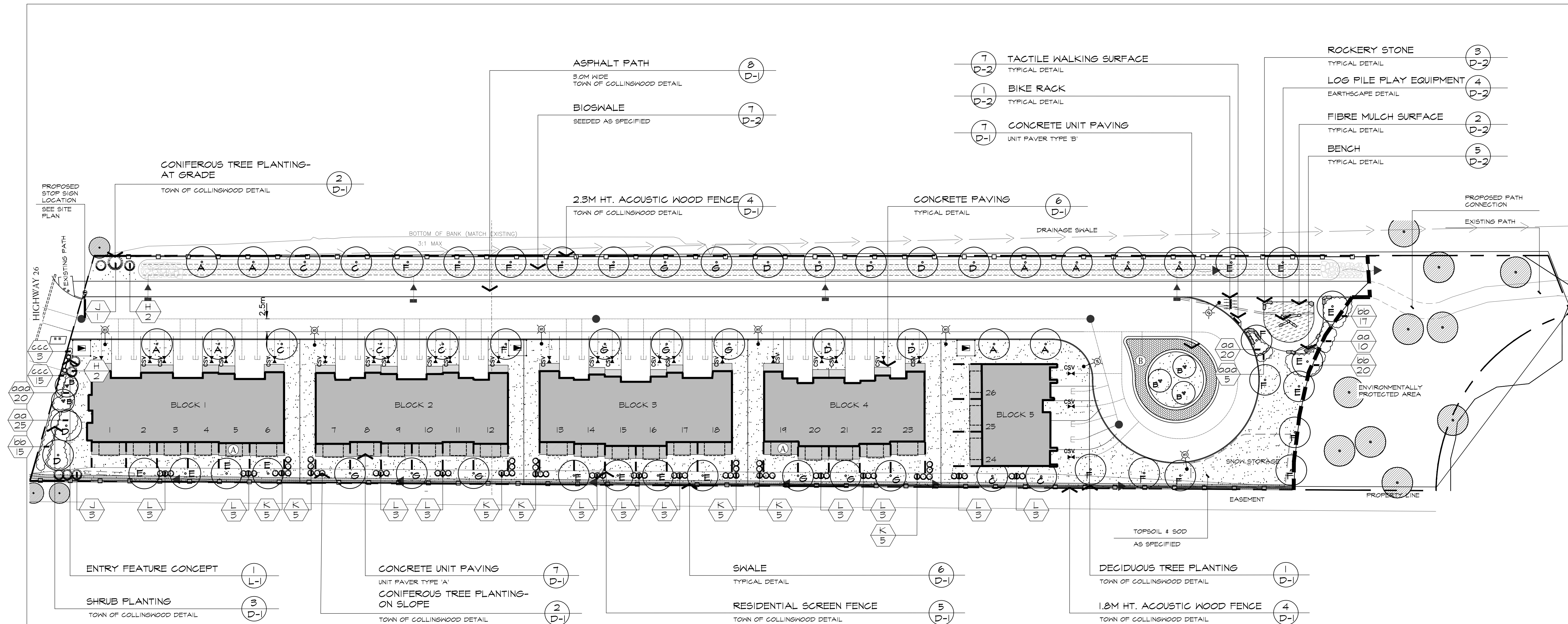

**CONCRETE UNIT PAVER - TYPE 'A' (A)**  
 MANUFACTURE: UNILOCK  
 STYLE: UMBRIANO  
 SIZE: RANDOM BUNDLE 6cm  
 PATTERN: UMBRIANO RANDOM B  
 COLOUR: SUMMER WHEAT

**CONCRETE UNIT PAVER - TYPE 'B' (B)**  
 MANUFACTURE: UNILOCK  
 STYLE: TOWN HALL PAVERS  
 SIZE: 4" X 12"  
 PATTERN: HERRINGBONE  
 COLOUR: BASALT

**GENERAL GUIDE FOR STONE CLADDING:**

OVERALL PERCENTAGE BREAKDOWN FOR SIZES	REQUIRED SIZE	SIZES BREAKDOWN IN PERCENTAGE PER NATURAL STONE
60%	2'-4"	80% KINGSTON LIMESTONE
40%	5'-8"	20% KINGSTON HUE SANDSTONE - LANDSDOWNE BUFF

**LOCATION OF SEED TYPES ARE NOTED ON PLAN**

SEED WITH THE FOLLOWING SEED MIXTURES AS SUPPLIED BY ONTARIO SEED COMPANY (1-800-465-5849) OR APPROVED EQUAL

**OSC # 8175 - FACW WETLAND SEED MIXTURE**

BEBB'S SEDGE ( <i>Carex bebbii</i> )	1%
BLUE LOBELIA ( <i>Lobelia siphilitica</i> )	1%
BLUE VERVAIN ( <i>Verbena hastata</i> )	4%
BLUNT BROOM SEDGE ( <i>Carex scoparia</i> )	1%
BONSET ( <i>Eupatorium perfoliatum</i> )	1%
FOX SEDGE ( <i>Carex vulpinoidea</i> )	25%
GREEN BULRUSH ( <i>Scirpus atrovirens</i> )	8%
HEATH ASTER ( <i>Aster pilosus</i> )	1%
LURID SEDGE ( <i>Carex lurida</i> )	10%
NEW ENGLAND ASTER ( <i>Aster novae-angliae</i> )	1%
PURPLE STEMMED ASTER ( <i>Aster puniceus</i> )	1%
SOFT RUSH ( <i>Juncus effusus</i> )	1%
SPOTTED JOE PYE WEED ( <i>Eupatorium maculatum</i> )	1%
SQUARE STEMMED MONKEY FLOWER ( <i>Mimulus ringens</i> )	1%
SWAMP MILKWEED ( <i>Asclepias incarnata</i> )	1%
TALL MANNA GRASS ( <i>Glyceria grandis</i> )	1%
VIRGINIA WILD RYE ( <i>Elymus virginicus</i> )	40%
WOOLGRASS ( <i>Scirpus oyperinus</i> )	1%

SEED RATE: 22-25 kg/ha

**NURSE CROP**

ANNUAL RYE GRASS (*Lolium multiflorum*)  
 SEED RATE: 28kg/ha

**PLANT LIST**

PROJECT NAME: 11589 HIGHWAY 26 CRANBERRY MARSH ESTATES - (ABAL 3523)

In the event of a discrepancy between the planting plan and the plant list quantities, the planting plan shall govern.

KEY	QUANTITY	BOTANICAL NAME	COMMON NAME	CALIPER	HEIGHT	SPREAD	ROOT	REMARKS	SPACING
<b>DECIDUOUS TREES</b>									
A	10	AGER X FREEMANII 'AUTUMN BLAZE'	AUTUMN BLAZE MAPLE	6.0mm	3500mm	1500mm	W.B.	EQUAL FORM	----
B	5	AMELANGHIER CANADENSIS	SERVICEBERRY	3 X 5.0mm	3500mm	1500mm	W.B.	MULTI-STEM	----
C	7	GINKGO BILOBA 'PRINCETON SENTRY'	PRINCETON SENTRY MAIDENHAIR TREE	6.0mm	3500mm	1500mm	W.B.	EQUAL FORM	----
D	9	GLEDITSIA TRIAGANTHOS 'STREET KEEPER'	STREET KEEPER HONEY-LOCUST	6.0mm	3500mm	1500mm	W.B.	EQUAL FORM	----
E	13	CELTIS OCCIDENTALIS	HACKBERRY	6.0mm	3500mm	1500mm	W.B.	EQUAL FORM	----
F	13	QUERCUS BIGLOR	SHAMP WHITE OAK	6.0mm	3500mm	1500mm	W.B.	EQUAL FORM	----
G	11	TILIA AMERICANA	BASSWOOD	6.0mm	3500mm	1500mm	W.B.	EQUAL FORM	----
<b>CONIFEROUS TREES</b>									
H	4	THUJA OCCIDENTALIS 'DEGROOT'S SPIRE'	DEGROOT'S SPIRE CEDAR	----	2500mm	800mm	W.B.	SPECIMEN	----
J	4	PINUS STROBUS	EASTERN WHITE PINE	----	3500mm	1000mm	W.B.	SPECIMEN	----
K	35	PINUS STROBUS 'STONE PILLAR'	STONE PILLAR EASTERN WHITE PINE	----	3500mm	1000mm	W.B.	SPECIMEN	----
L	33	THUJA OCCIDENTALIS 'EMERALD'	EMERALD CEDAR	----	3500mm	1000mm	W.B.	SPECIMEN	----
<b>DECIDUOUS SHRUBS</b>									
aa	55	HYDRANGEA ARBORESCENS 'ANNABELLE'	ANNABELLE HYDRANGEA	----	500mm	500mm	3 gal. POT	MIN. 2 YRS. 6TH.	650mm
bb	52	CORNUS SERICEA 'ARCTIC FIRE'	ARCTIC FIRE DOGWOOD	----	800mm	----	3 gal. POT	MIN. 2 YRS. 6TH.	750mm
<b>PERENNIALS, AND GRASSES</b>									
ooo	25	SEDUM 'AUTUMN JOY'	AUTUMN JOY STONECROP	----	----	----	3 gal. POT	MIN. 2 YRS. 6TH.	500mm
ccc	18	FENISETUM ALOPECUROIDES	FOUNTAIN GRASS	----	----	----	3 gal. POT	MIN. 2 YRS. 6TH.	500mm

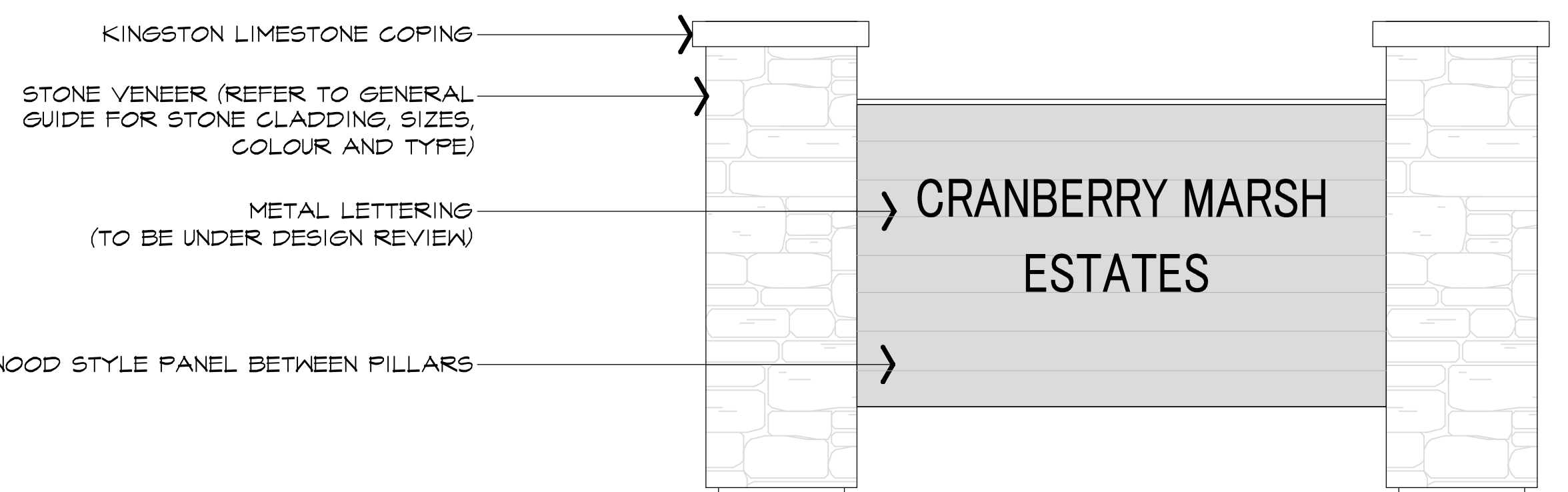

**1 ENTRY FEATURE CONCEPT**

NOTE: CONTRACTOR RESPONSIBLE FOR PROVIDING SHOP DRAWINGS STAMPED BY A STRUCTURAL ENGINEER FOR FINAL APPROVAL BY LANDSCAPE ARCHITECT. STRUCTURAL WORKS TO BE REVIEWED AND CERTIFIED BY THE DESIGN ENGINEER.

NT5





**5 BENCH** NTS  
 MODEL: P.9 682-AL-EK-EK-SD-BD-T4  
 MANUFACTURER: HAUSER SITE FURNITURE (800-268-1528 -TRUDY WALKER)  
 PRODUCT: KINGS MILL ARC BENCH WITH ENVIRO WOOD SLATS  
 SIZE: 188.0cm X 56.5cm X 74.4cm SEAT HEIGHT 45.1cm  
 COLOUR: WALNUT  
 OTHER: SUN-METAL POWDER COAT FINISH  
 NOTE: OPTIONAL SKATEBOARD DEFLECTOR  
 OR APPROVED EQUAL



**1 BIKE RACK** NTS  
 MAGLIN 350 SERIES BIKE RACK (3 RINGS)

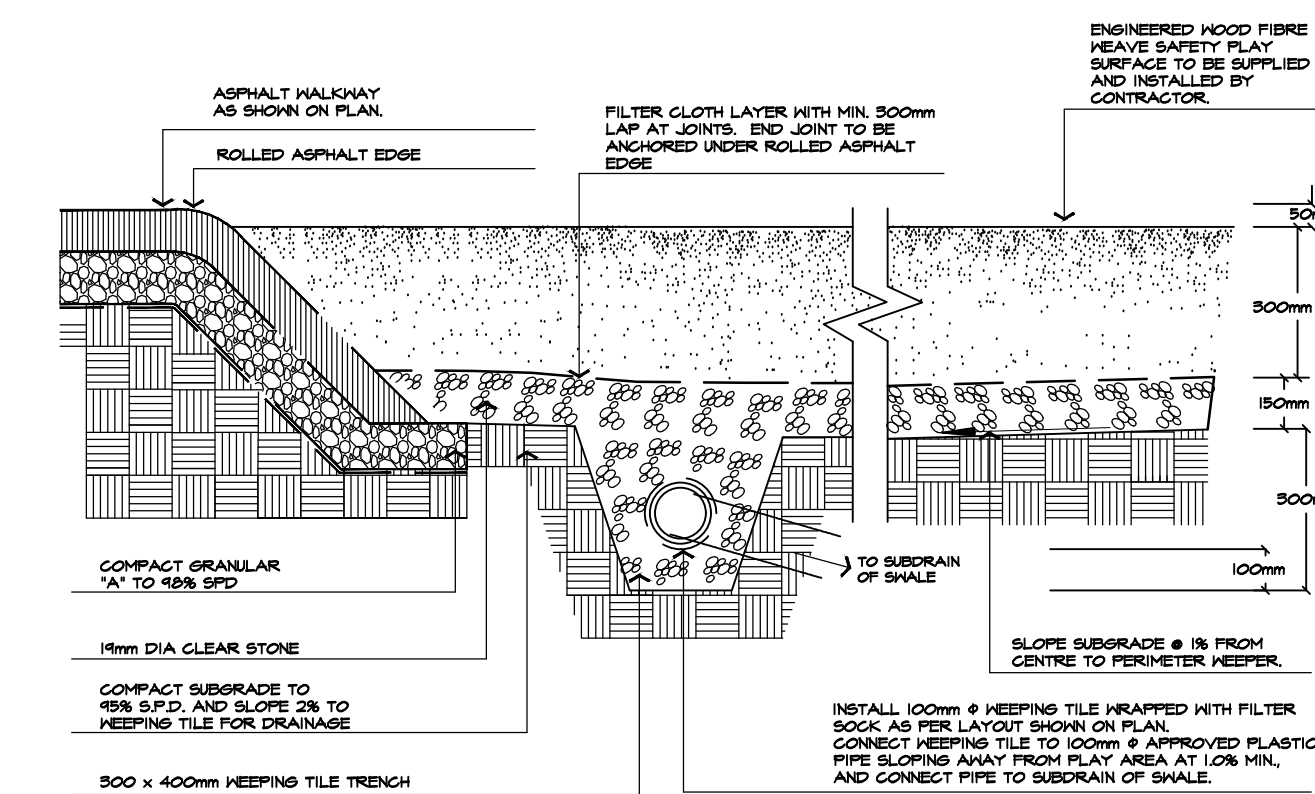

**2 FIBRE WEAVE SAFETY SURFACE** NTS  
 ABAL G183K041T

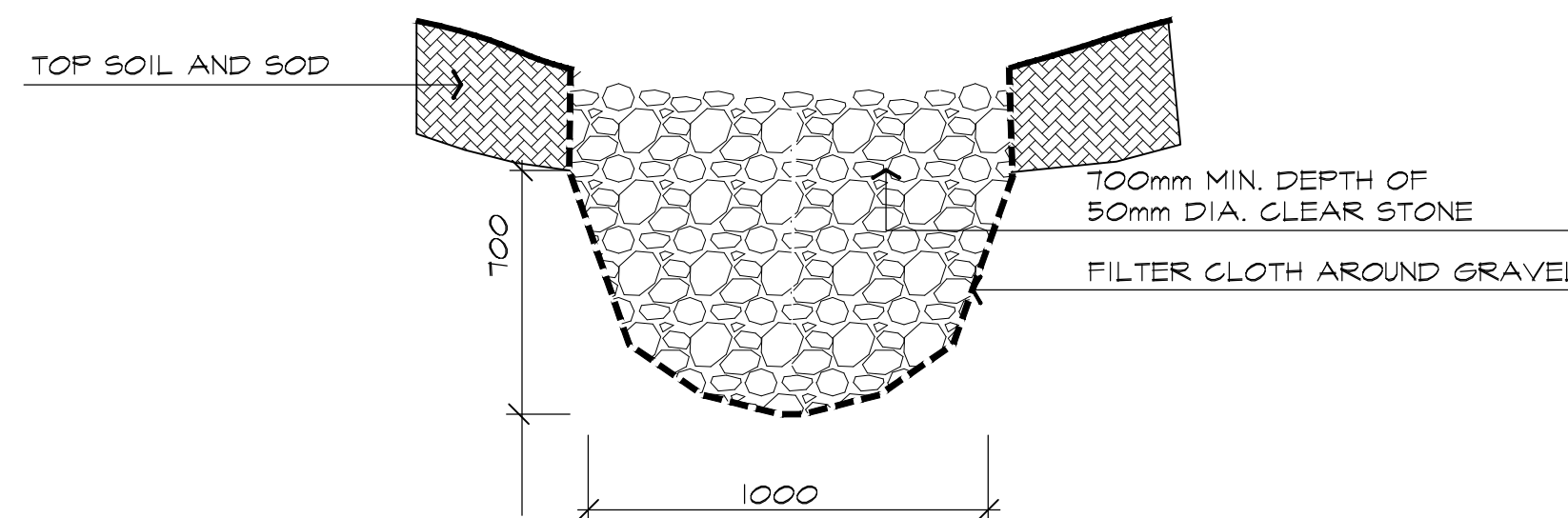

**6 SWALE DETAIL** NTS  
 TYPICAL INSTALLATION

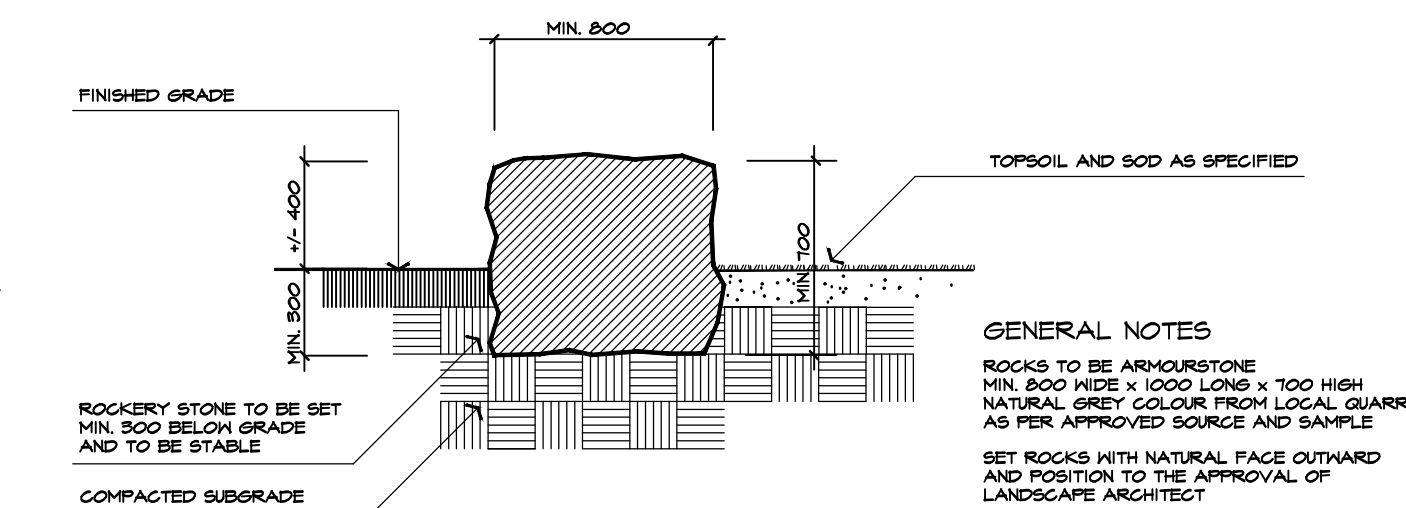

**3 ROCKERY STONE DETAIL** NTS  
 ABAL R201-85091T

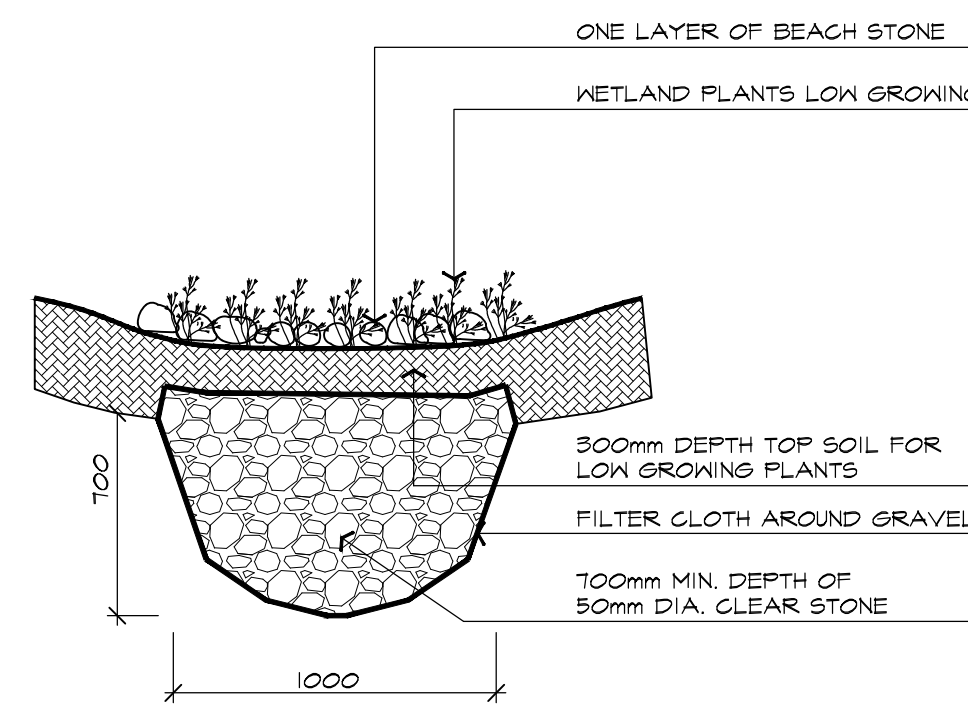

**7 BIOSWALE DETAIL** NTS

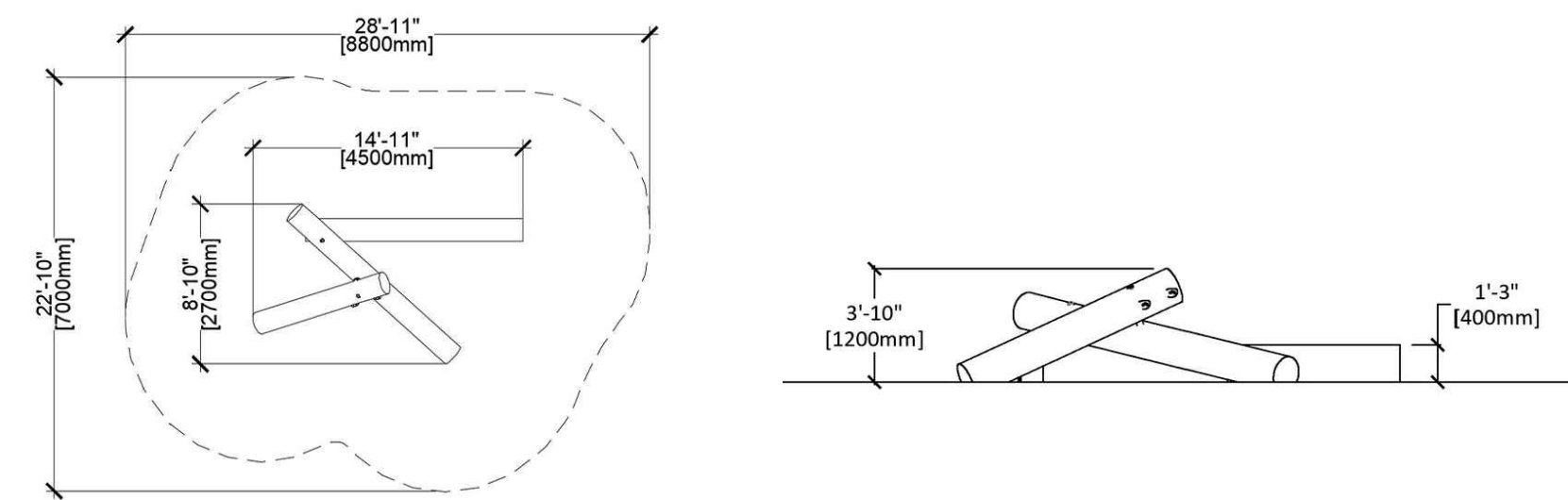

**4 LOG PILE PLAY EQUIPMENT** NTS  
 EARTHSCAPE 'LOG PILE 3.1'

no.	date	version	by
2.	AUG 1 2023	ISSUED FOR SUBMISSION	LE /EK
1.	DEC 5 2022	ISSUED FOR SUBMISSION	KM /EK
0.	OCT.22 2021	ISSUED FOR CLIENT REVIEW	NH

All information hereon to be checked and verified at the site and any discrepancies must be reported to and clarified by the landscape architect before commencing work. All drawings, specifications, details, digital information, etc., prepared by the landscape architect are instruments of service and as such are his property and must be returned at his request.

ASSOCIATION OF LANDSCAPE ARCHITECTS ONTARIO

ALEXANDER BUDREVICS & ASSOCIATES LIMITED  
 LANDSCAPE ARCHITECTS

895 Don Mills Road, Second Tower, Suite 212  
 Toronto, Ontario, Canada, M3C 1W3

416.444.5201  
 416.444.5208

www.budrevics.com

project  
**11589 HIGHWAY 26 CRANBERRY MARSH ESTATES**  
 HIGHWAY 26  
 TOWN OF COLLINGWOOD  
 CRANBERRY MARSH ESTATES

drawing  
**LANDSCAPE DETAILS**

date	OCT 20, 2021	drawn	NH
scale*	AS SHOWN	file	3523 D2 V2-010823
direction		project no.	3523
		sheet no.	D-2

\*NOTED SCALE IS APPLICABLE ONLY WHEN PRINTED ON ARCH D (34"x46") SIZE SHEET



August 1, 2023

3523

**COST ESTIMATE FOR LANDSCAPE WORKS - Drawing Version 3**

*For Letter of Credit Purposes*

895 Don Mills Road, Second Tower, Suite 212  
Toronto, Ontario, Canada, M3C 1W3

☎ 416.444.5201  
✉ 416.444.5208

**CRANBERRY MARSH ESTATES**

11589 Highway 26  
Collingwood, Ontario

**Cranberry Marsh Estates**

**1. Hard Surfaces**

Concrete walkway	120	m2	@	\$100	\$	12,000.00
Concrete unit paving	505	m2	@	\$125	\$	63,125.00
Asphalt walkway	745	m2	@	\$90	\$	67,050.00
Fibre mulch	65	m2	@	\$80	\$	5,200.00
Tactile walking surface	1	EA	@	\$450	\$	450.00
			Subtotal :		\$	<b>147,825.00</b>

**2. Plant Material**

Deciduous trees (60mm cal.)	63	EA	@	\$500	\$	31,500.00
Ornamental trees (50mm cal.)	5	EA	@	\$350	\$	1,750.00
Coniferous trees (2500-3500mm ht.)	76	EA	@	\$400	\$	30,400.00
Deciduous Shrubs (400-600mm spr.)	107	EA	@	\$45	\$	4,815.00
Bioswale seed mix	461	m2	@	\$5	\$	2,305.00
Perennials (3 gal. pot)	43	EA	@	\$20	\$	860.00
Soil for planting beds (Soil + Mulch)	545	m2	@	\$50	\$	27,250.00
Topsoil (150mm Depth)	2873	m2	@	\$6	\$	17,238.00
Sod	2525	m2	@	\$6	\$	15,150.00
			Subtotal :		\$	<b>131,268.00</b>

**3. Site Furnishing**

Bike rack (5 bikes/ unit)	1	EA	@	\$1,800	\$	1,800.00
Log pile play equipment	1	EA	@	\$5,000	\$	5,000.00
Bench	1	EA	@	\$5,000	\$	5,000.00
Rockery stone	17	EA	@	\$500	\$	8,500.00
			Subtotal :		\$	<b>6,800.00</b>

**4 Tree Preservation**

Tree Preservation Fencing	51	LM	@	\$50	\$	2,550.00
			Subtotal :		\$	<b>2,550.00</b>

**TOTAL COST WORK ON SITE**

**\$ 288,443.00**

Note : This cost estimate does not include concrete paving at ground level, concrete curb, asphalt, engineered retaining walls, lighting, structural foundations or engineering fees.

Issued by Alexander Budrevics and Associates Limited.

Eriks Kalvins, OALA CSLA  
Principal Landscape Architect

